

COFFEE SYSTEMS
INSTALLATION GUIDE



Contents

- 2 Coffee Systems
- 3 Specifications
- 5 Installation
- 5 Troubleshooting

Features and specifications are subject to change at any time without notice.

Important Note

To ensure this product is installed and operated as safely and efficiently as possible, take note of the following types of highlighted information throughout this guide:

IMPORTANT NOTE highlights information that is especially important.

CAUTION indicates a situation where minor injury or product damage may occur if instructions are not followed.

WARNING states a hazard that may cause serious injury or death if precautions are not followed.

IMPORTANT NOTE: Save these instructions for the local electrical inspector.

Product Information

Important product information including the model and serial number are listed on the product rating plate. The unit must be slid forward to view the rating plate. Refer to the illustration below.

If service is necessary, contact Wolf factory certified service with the model and serial number.

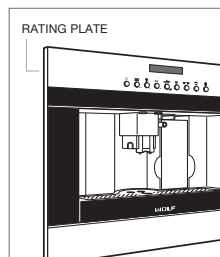

Rating plate location.

IMPORTANT INSTRUCTIONS

⚠ CAUTION

- Installation must be performed by a qualified professional in compliance with legislation in force in the country of installation (see section “Built-in installation”).
- The packing elements (plastic bags, polystyrene foam, etc.) should be kept out of reach of children.
- Never install the appliance in rooms where the temperature may drop to 0°C or lower.
- Customize the water hardness as soon as possible following the instructions in the use & care guide.

IMPORTANT INSTRUCTIONS

⚠ WARNING

- Check that the main power supply voltage corresponds to the value indicated on the rating plate on the side of the appliance.
- If the power socket does not match the plug on the appliance, have the socket replaced with a suitable type by a qualified professional.
- Do not use multiple sockets or extensions.

⚠ CAUTION

Safety cutout devices must be included in the main power supply in compliance with the installation regulations in the country concerned.

SPECIFICATIONS

Installation Requirements

The coffee system can be installed in a standard or flush inset application. A minimum base support of 45 kg is required. The sides of the cabinetry opening must be adequate to support installation of the mounting slides.

Finish the edges of the opening. They may be visible when the unit is slid forward.

The unit has face trim on the top, bottom and both sides that will overlap stiles and rails. Refer to the chart below for trim overlaps. For flush inset installations, a minimum 3 mm reveal is required on all four sides. To ensure consistent 3 mm reveals, each corner of the opening must be exactly 90°.

The Wolf coffee system is designed and agency approved for installation with Wolf cooktops, built-in ovens, microwaves and warming drawers only.

TRIM OVERLAP

OVERLAP	
Top	5 mm
Bottom	0 mm
Sides	18 mm

Electrical

Installation must comply with all applicable electrical codes and be properly grounded (earthed).

Locate the electrical supply as shown in the illustrations on page 4. A separate circuit, servicing only this appliance is required. A ground fault circuit interrupter (GFCI) is not recommended and may cause interruption of operation.

ELECTRICAL REQUIREMENTS

Electrical Supply	220-240 VAC, 50/60 Hz
Service	5.6 amps
Power Cord	1.8 m

IMPORTANT NOTE: Connection of this appliance should be through a fused connection unit or a suitable isolator, which complies with national and local safety regulations. The on/off switch should be easily accessible after the appliance has been installed. If the switch is not accessible after installation (depending on country) an additional means of disconnection must be provided for all poles of the power supply. When switched off there must be an all pole contact gap of 3 mm in the isolator switch. This 3 mm contact disconnect gap must apply to any isolator switch, fuses and/or relays according to EN60335.

SPECIFICATIONS

Coffee System

STANDARD INSTALLATION

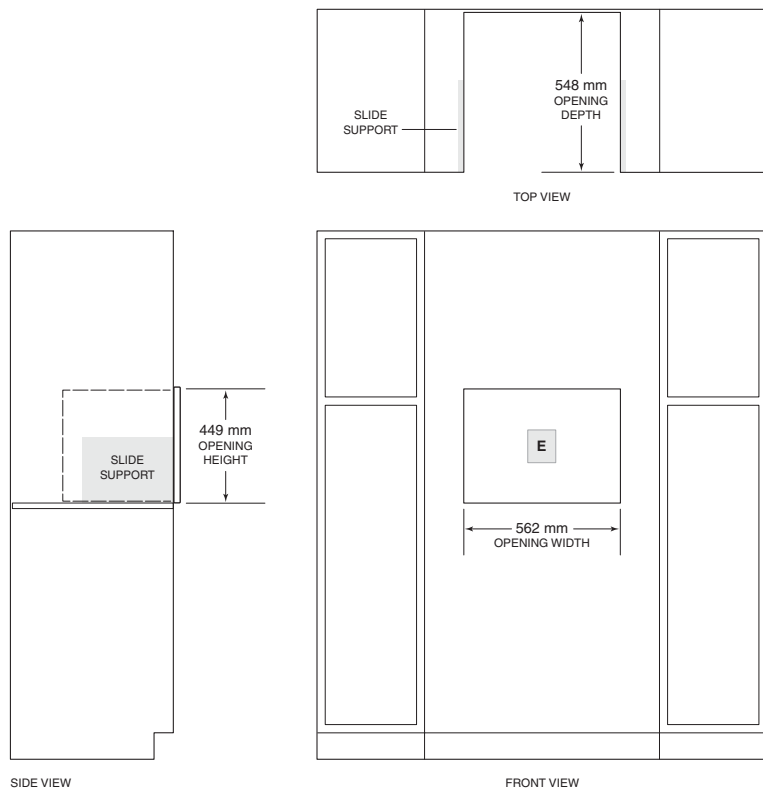

NOTE: Dashed line represents profile of unit.

Coffee System

FLUSH INSET INSTALLATION

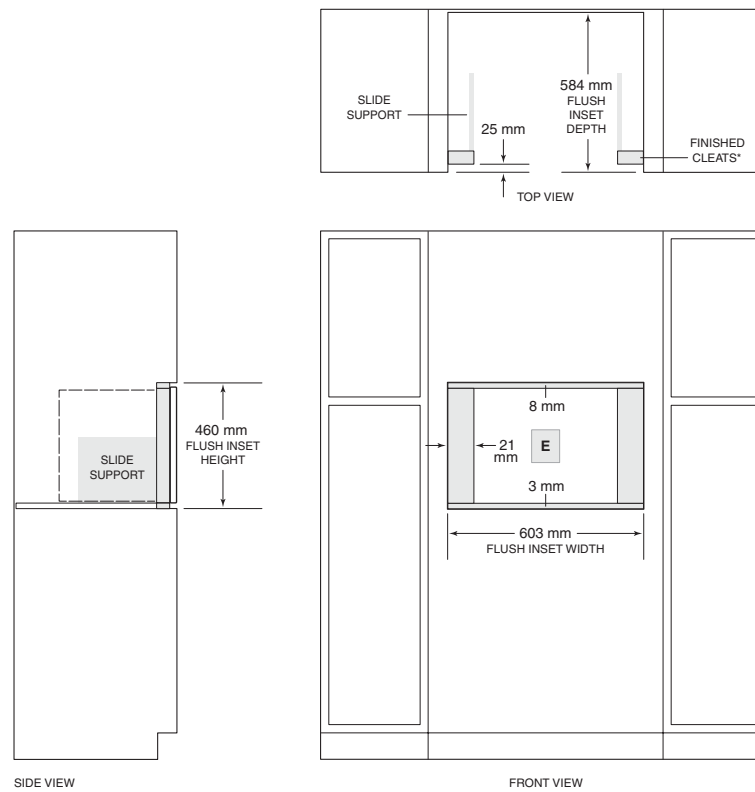

*Will be visible and should be finished to match cabinetry.
Dashed line represents profile of unit.

INSTALLATION

Installation

- 1 Ensure the sides of the cabinetry opening are adequate to support installation of the slides. If necessary, install additional side cleats maintaining the opening width.
- 2 Position slides on the sides of the cabinet opening as shown in the illustration below. Spacer material provided, can be added under or at the sides of the cabinet to ensure a proper fit. If the unit is to be installed over a warming drawer, use the top surface as a reference to position slides (there will be no surface to rest the slides on).
- 3 Secure the slides with screws provided. Extend slides forward to full extension.
- 4 Position the unit on the slides. Verify the pins are inserted into the housings properly, then secure with screws provided. If the height of the unit requires adjustment, use the spacer disks provided. Refer to the illustration below.
- 5 Secure the power cord clip provided to the top of the cabinet opening, centered and approximately 356 mm back from the front edge. Position the power cord through it and plug into the electrical outlet on the back wall of the opening. The power cord must be long enough to allow the unit to be slid forward.

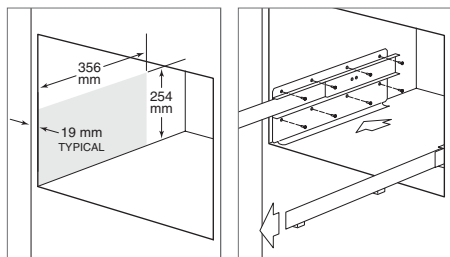

Slide support.

Install slides.

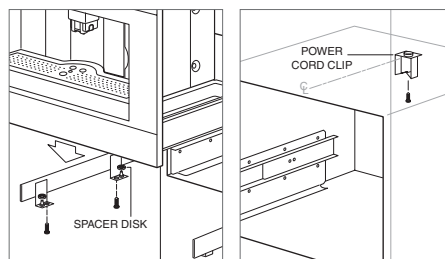

Install unit on slides.

Install power cord clip.

COMPLETE THE INSTALLATION

- 1 Fill the water tank.
- 2 Slide unit forward and press the main power switch located behind the front (right) control panel.
- 3 Select desired language. To select, scroll through languages until desired language is displayed, then press and hold .
- 4 Press . Hot water will be dispensed from the hot water spout.
- 5 The unit will turn off automatically after initial power up is complete.

Troubleshooting

IMPORTANT NOTE: If the coffee system does not operate properly, follow these troubleshooting steps:

- Verify electrical power is supplied to the unit.
- Verify proper electrical connections.
- If the coffee system does not operate properly, contact Wolf factory certified service. Do not attempt to repair the appliance. Wolf is not responsible for service required to correct a faulty installation.

825028 REV-A 5/2014

