

DROP DOWN DOOR MICROWAVE OVENS

INSTALLATION GUIDE



DROP DOWN DOOR MICROWAVE OVENS

Contents

- 2 Drop Down Door Microwave Ovens
- 3 Specifications
- 4 Installation
- 4 Troubleshooting

Features and specifications are subject to change at any time without notice.

Important Note

To ensure this product is installed and operated as safely and efficiently as possible, take note of the following types of highlighted information throughout this guide:

IMPORTANT NOTE highlights information that is especially important.

CAUTION indicates a situation where minor injury or product damage may occur if instructions are not followed.

WARNING states a hazard that may cause serious injury or death if precautions are not followed.

IMPORTANT NOTE: Save these instructions for the local electrical inspector.

Product Information

Important product information including the model and serial number are listed on the product rating plate. The rating plate is located on the lower left side of the front face frame. The oven door must be open to view the rating plate. Refer to the illustration below.

If service is necessary, contact Wolf factory certified service with the model and serial number.

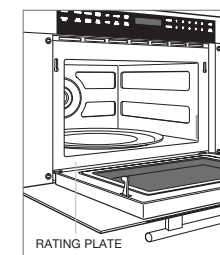

Rating plate location.

SPECIFICATIONS

Installation Requirements

The drop down door microwave oven can be installed in a standard or flush inset application.

Finish the edges of the opening. They may be visible when the door is open.

For standard installations, face trim will overlap stiles and rails. Refer to the chart.

For flush inset installations, a minimum 3 mm reveal is required on all sides. To ensure consistent reveals, each corner of the opening must be exactly 90°.

If the drop down door microwave oven is installed above or below a Wolf E series oven in a flush inset application, a 6 mm reveal is required.

INSTALLATION REQUIREMENTS			
BASE SUPPORT			MIN
Drop Down Door Microwave			57 kg
TRIM OVERLAP		610 mm MODEL	762 mm MODEL
Top	5 mm	5 mm	
Bottom	0 mm	0 mm	
Sides	18 mm	98 mm	

Electrical

Installation must comply with all applicable electrical codes and be properly grounded (earthed).

Locate the electrical supply as shown in the illustrations on the following pages. The receptacle may also be located in an adjacent cabinet within reach of the power cord. A separate circuit, servicing only this appliance is required. A ground fault circuit interrupter (GFCI) is not recommended and may cause interruption of operation.

ELECTRICAL REQUIREMENTS	
Electrical Supply	220-240V, 50Hz
Service	1600 Watts
Power Cord	1.2 m

IMPORTANT NOTE: Connection of this appliance should be through a fused connection unit or a suitable isolator, which complies with national and local safety regulations. The on/off switch should be easily accessible after the appliance has been installed. If the switch is not accessible after installation (depending on country) an additional means of disconnection must be provided for all poles of the power supply. When switched off there must be an all pole contact gap of 3 mm in the isolator switch. This 3 mm contact disconnect gap must apply to any isolator switch, fuses and/or relays according to EN60335.

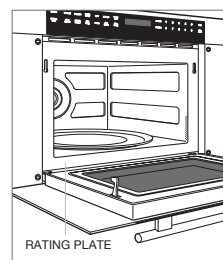

Rating plate location.

Drop Down Door Microwave Oven

STANDARD INSTALLATION

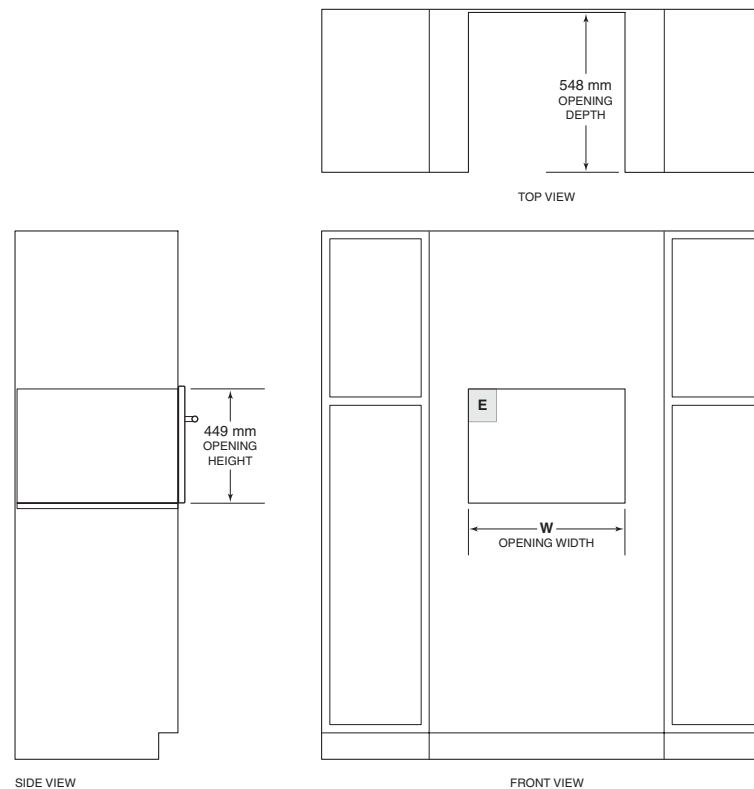

NOTE: 610 mm and 762 mm models require the same opening dimensions.

OPENING WIDTH	
MICROWAVE OVEN	W
610 mm Model	562 mm
762 mm Model	562 mm

SPECIFICATIONS

Drop Down Door Microwave Oven

FLUSH INSET INSTALLATION

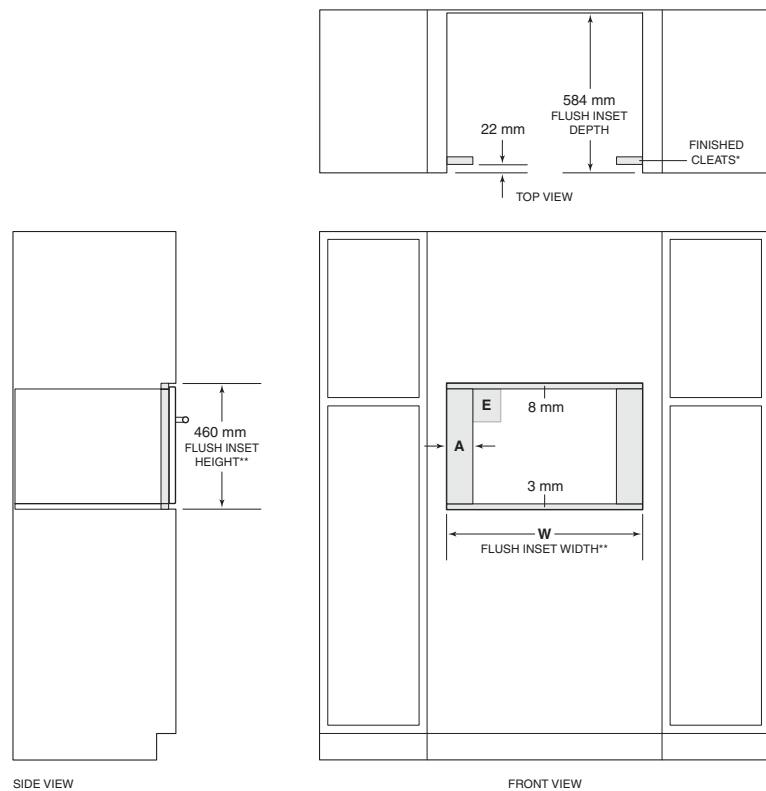

*Will be visible and should be finished to match cabinetry.
 **Dimension provides minimum reveals.

OPENING WIDTH		
MICROWAVE OVEN	W	A
610 mm Model	603 mm	21 mm
762 mm Model	765 mm	102 mm

INSTALLATION

Installation

- 1 Turn power off to the electrical outlet.
- 2 Move the unit near the opening. Remove and recycle packing materials.
- 3 The unit is shipped with two shipping brackets located on each side, behind the front face. Remove both brackets, then reinstall screws. Refer to the illustration below.
- 4 Connect the appliance to the fixed wiring.
- 5 Position the microwave oven in the opening and slide back until the mounting flange is flush with the face of the cabinet. Avoid pinching the power cord between the unit and cabinet wall.
- 6 Open the door. Using the two holes on either side of the mounting flange as a template, drill pilot holes into the cabinet.
- 7 Mount the microwave oven using four screws provided. Refer to the illustration below.
- 8 Turn power back on to the electrical outlet.

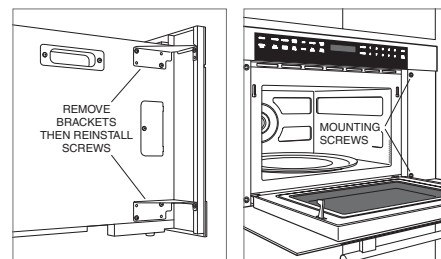

Shipping brackets.

Mounting screws.

Troubleshooting

IMPORTANT NOTE: If the drop down door microwave oven does not operate properly, follow these troubleshooting steps:

- Verify electrical power is supplied to the microwave oven.
- Verify proper electrical connections.
- If the microwave oven does not operate properly, contact Wolf factory certified service. Do not attempt to repair the oven. Wolf is not responsible for service required to correct a faulty installation.

Wolf, Wolf & Design, Wolf Gourmet, W & Design and the color red as applied to knobs are registered trademarks and service marks of Wolf Appliance, Inc. Sub-Zero, Sub-Zero & Design, Dual Refrigeration, The Living Kitchen, Great American Kitchens The Fine Art of Kitchen Design, and Ingredients are registered trademarks and service marks of Sub-Zero, Inc. All other trademarks or registered trademarks are property of their respective owners in the United States and other countries.

9004762 REV-A 5/2015

