

FEATURES

- Upper cabinet refrigerator and two freezer storage drawers.
- Custom front panels and hardware allow for infinite design options.
- Point-of-use refrigeration that can be placed anywhere in the home.
- Dual refrigeration preserves food’s goodness in self-contained compartments.
- Redesigned sleek, minimalist interior is lit by LEDs to reduce heat.
- Interactive control panel with touch screen and precise temperature control.
- Air purification system reduces odors, bacteria, viruses and ethylene gas.
- Internal dispenser provides filtered, chilled water inside refrigerator.
- Advanced water filtration system.
- Automatic ice maker with max ice feature to increase ice production up to 30 percent.
- Adjustable shelves are engineered for liquid nano-retention, so spills stay put.
- Dampened hinges.
- Smart Grid ready.
- Informational freshness cards inside the refrigerator for easy reference.
- Star-K certified.



MODEL OPTIONS

COMBINATION	
Model	ICBIT-36CIID

INTERIOR FEATURES

REFRIGERATOR
3 Adjustable glass shelves
1 Stationary shelf
Crisper drawer with 2 adjustable dividers
Adjustable dairy compartment
2 Adjustable door shelves
1 Stationary door shelf

FREEZER
3 Adjustable drawer dividers
Removable ice container

ACCESSORIES

- Stainless steel front panels with tubular or pro handles and 102 mm or 152 mm toe kick.
- Stainless steel tubular and pro handles.
- Dual installation kit.
- Dozen egg container.

Accessories available through an authorized Sub-Zero dealer.

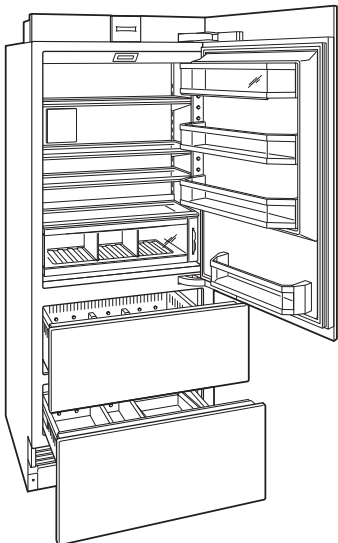

SPECIFICATIONS	
PRODUCT	
Dimensions	914 W x 2134 H x 610 D
Weight	209 kg
CAPACITY	
Refrigerator	359 L
Freezer	130 L
ELECTRICAL	
Supply	220-240 V AC, 50/60 Hz
Service	10 amp circuit
PLUMBING	
Supply	1/4" OD copper, braided stainless steel or PEX tubing
Pressure	2.4–8.3 bar

Overall dimensions do not include panels or handles. Dimensions will vary with panel thickness.

The depth of each integrated model is 610 mm. Allow for panel thickness when planning the finished opening depth.

Specifications are subject to change without notice.

Dimensions may vary ± 3 mm.

DIMENSIONS

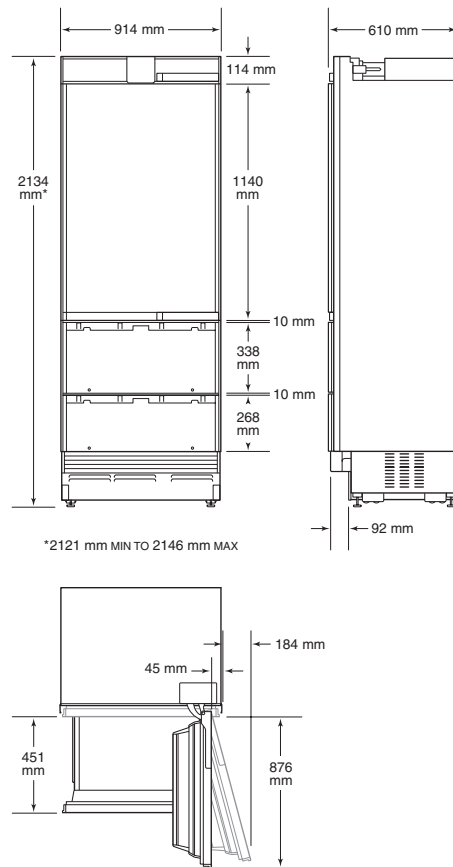

ELECTRICAL

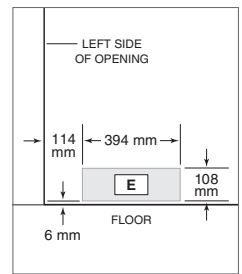

PLUMBING

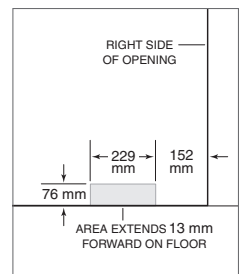

INSTALLATION

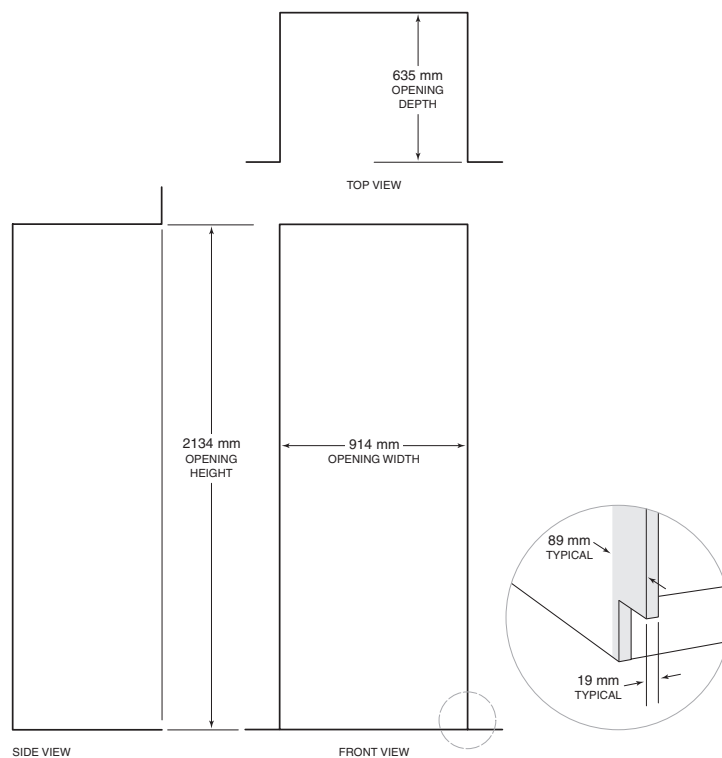

NOTE: Shaded areas will be visible and should be finished to match cabinetry.